

固態繼電器  
SOLID STATE RELAY

AT1008D

AT10 SERIES

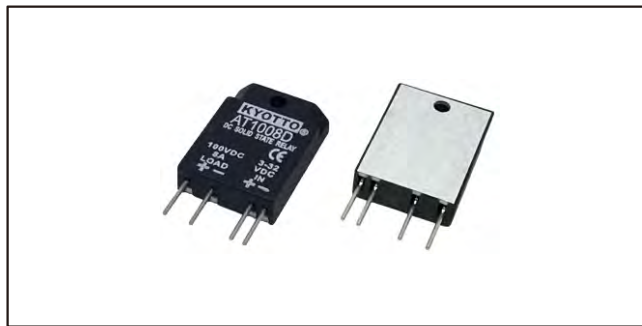

型號索引說明 Model No. Descriptions:

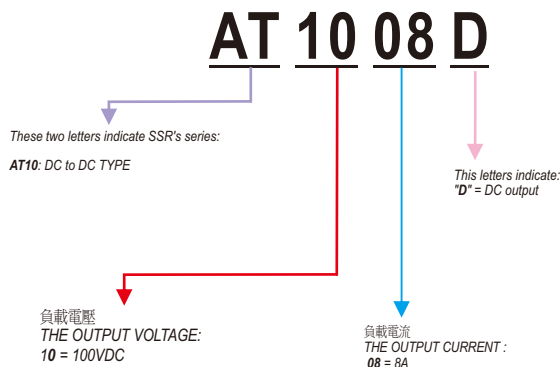

產品摘錄 PRODUCT SELECTON

輸出規格 OUTPUT SPECIFICATIONS

品名	Description	AT1008D
負載電壓範圍	Operating Voltage [VDC]	3-100VDC
最大負載電流 (25°C)	Max Load Current (25°C)	8A
破壞電壓	Maximum Transient Overvoltage [Vpk]	100
洩露電流	Maximum Off-State Leakage Current @Rated Voltage [mA]	0.1mA
最大瞬間承受電流	Maximum Surge Current [A] (10ms)	16A
常態導通電阻	Typical On resistance (I <sub>s</sub> =10mA, I <sub>t</sub> =Max. Within 1s) Ron	0.01Ω
最大導通電阻	Maximum On resistance (I <sub>s</sub> =10mA, I <sub>t</sub> =Max. Within 1s) Ron	0.03Ω

輸入規格 INPUT SPECIFICATIONS

品名	Description	AT1008D
控制電壓範圍	Control Voltage Range	3-32VDC
最小導通電壓	Minimum Turn-on Voltage	3.0
最小關斷電壓	Minimum Turn-off Voltage	1.0
輸入電流	Typical Input Current	15mA
最大動作時間	Maximum Turn-on Time [mSec]	2.5m Sec
最大關斷時間	Maximum Turn-off Time [mSec]	0.5m Sec

一般規格 GENERAL SPECIFICATIONS

品名	Description	AT1008D
輸入/輸出至外殼絕緣電壓	Dielectric Strength, Input-Output Base (50/60Hz)	-
輸入/輸出絕緣電壓	Dielectric Strength, Input-Output (50/60Hz)	2500
絕緣電阻	Minimum Insulation Resistance	10 <sup>9</sup> ohm
工作溫度範圍	Ambient Operating Temperature Range	-20°C~+80°C
儲存溫度範圍	Ambient Storage Temperature Range	-40°C~+100°C
觸發方式	Switching Type	MOSFET
重量	Weight (g)	10g

GENERAL NOTES

- (1) All parameters at 25°C unless otherwise specified
- (2) Dielectric strength and insulation resistance are measured between input and output
- (3) Heat sinking require, for derating curves see next page.

# 等效電路圖 EQUIVALENT CIRCUIT

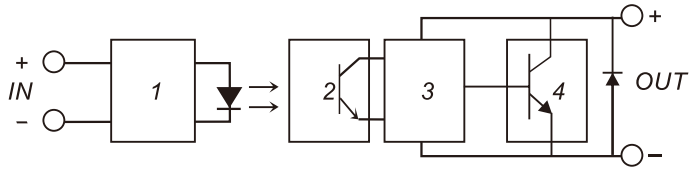

- 1.INPUT CIRCUIT
- 2.PHOTO DETECTOR
- 3.AMPLIFIER
- 4.PROTECTED CIRCUIT

# 外觀尺寸圖 MECHANICAL DIMENSIONS (Unit:mm) ± 0.5mm

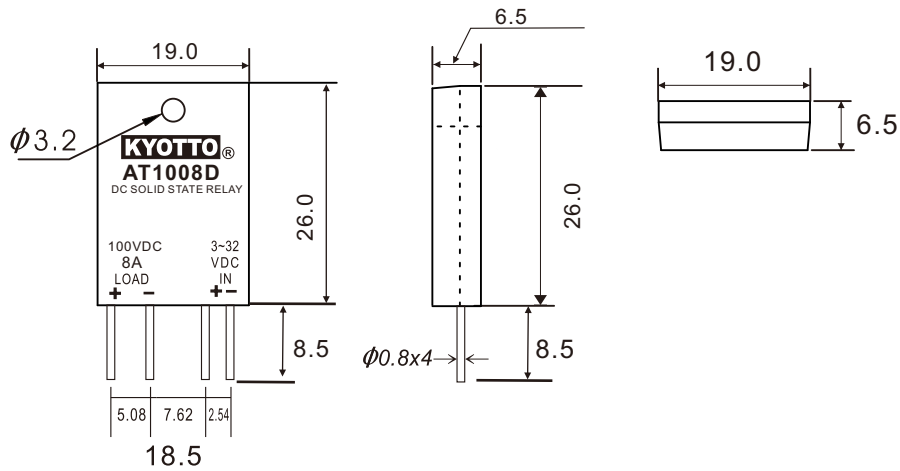

# 特性曲線圖 CHARACTERISTIC CURVES

